



Strain relief type ZL-MH



Product information

The ZL-MH strain relief plates are based on the ZL strain relief plate. By inserting the brass grommets, the ZL strain relief plate is free of fastening forces.

Approved for railway technology (EN 45545-2 / NFPA 130)

Information, conformities and approvals

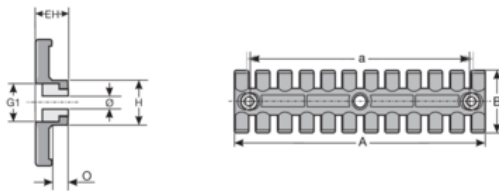

Article	Order No.	Color	No. Cables	PU pcs.
with brass sleeve, assembly with M5 screws				
ZL-MH 39	87701210	Black	3	1
ZL-MH 39, VE 50	87701211	Black	3	50
ZL-MH 60	87701212	Black	4	1
ZL-MH 87	87701214	Black	6	1
ZL-MH 103	87701216	Black	7	1
ZL-MH 121	87701218	Black	8	1
ZL-MH 140	87701220	Black	9	1
ZL-MH 140, VE 50	87701221	Black	9	50
ZL-MH 180	87701222	Black	12	1
with brass sleeve, assembly with M6 screws				
ZL-MH 39/6	87701270	Black	3	1
ZL-MH 60/6	87701272	Black	4	1



Strain relief type ZL-MH

Article	Order No.	Color	No. Cables	PU pcs.
ZL-MH 60, VE 50	87701213	Black	4	50
ZL-MH 70/6	87701274	Black	5	1
ZL-MH 87/6	87701278	Black	6	1
ZL-MH 87, VE 50	87701215	Black	6	50
ZL-MH 103/6	87701282	Black	7	1
ZL-MH 121/6	87701284	Black	8	1
ZL-MH 140/6	87701286	Black	9	1
ZL-MH 180/6	87701288	Black	12	1

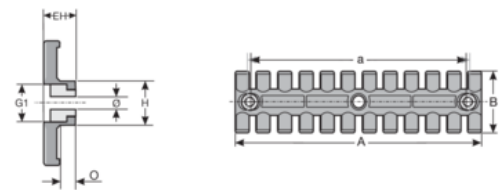

Article	Order No.	A mm	a mm	B mm	EH mm	G1 mm	H mm	O mm	Ø mm
ZL-MH 39	87701210	38.5	19.5	40	10	12	14	3.9	5.5
ZL-MH 39, VE 50	87701211	38.5	19.5	40	10	12	14	3.9	5.5
ZL-MH 60	87701212	59.5	43.5	40	10	12	14	3.9	5.5
ZL-MH 87	87701214	86.5	68	40	10	12	14	3.9	5.5
ZL-MH 103	87701216	102.5	84	40	10	12	14	3.9	5.5
ZL-MH 121	87701218	121	102.5	40	10	12	14	3.9	5.5
ZL-MH 140	87701220	139.5	121	40	10	12	14	3.9	5.5
ZL-MH 140, VE 50	87701221	139.5	121	40	10	12	14	3.9	5.5
ZL-MH 180	87701222	180	157	42	11.5	12	16	3.9	5.5

with brass sleeve, assembly with M6 screws

ZL-MH 39/6	87701270	38.5	19.5	40	10	12	14	3.9	6.5
------------	----------	------	------	----	----	----	----	-----	-----



Strain relief type ZL-MH

Article	Order No.	A mm	a mm	B mm	EH mm	G1 mm	H mm	O mm	Ø mm
ZL-MH 60/6	87701272	59.5	43.5	40	10	12	14	3.9	6.5
ZL-MH 60, VE 50	87701213	59.5	43.5	40	10	12	14	3.9	6.5
ZL-MH 70/6	87701274	69.5	43.5	40	10	12	14	3.9	6.5
ZL-MH 87/6	87701278	86.5	68	40	10	12	14	3.9	6.5
ZL-MH 87, VE 50	87701215	86.5	68	40	10	12	14	3.9	6.5
ZL-MH 103/6	87701282	102.5	84	40	10	12	14	3.9	6.5
ZL-MH 121/6	87701284	121	102.5	40	10	12	14	3.9	6.5
ZL-MH 140/6	87701286	139.5	121	40	10	12	14	3.9	6.5
ZL-MH 180/6	87701288	180	157	42	11.5	12	16	3.9	6.5

Material properties



Bar: Polyamide 6.6
Insert bushing: Brass Polyamide 6.6
Brass

Thermal properties



Temperature / temperature range -45 °C – 125 °C

Fire properties



Fire classification V0



Fire properties as per EN 45545-2C.I.T. R22 / R23 HL3 :0,44 EN 17084
Ds (max.) R22 / R23 HL3 :≥ 32 % ISO 4589-2
LOI R22 / R23 HL3 :59 ISO 5659-2



Resistant to:Alcohol
Greases
Fuels
Lyes
Mineral oils
Weak acids

Technical information



Halogen-free



Strain relief type ZL-MH

Technical information



LABS free



According to ISO 4892-2

Assembly method



Strain relief



Conformity



RoHS (EC Directive 2011/65/EU)

Approvals and operating permits



EU railway approval

Classification



ETIM 9: EC000322
ECLASS 14: 27400604

General information



Made in Germany